

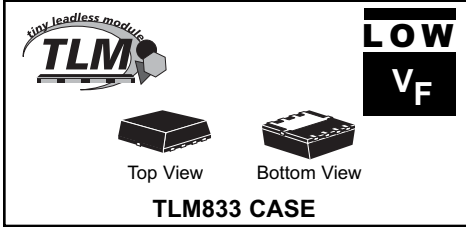

CTLSH3-30M833

**SURFACE MOUNT SILICON  
LOW  $V_F$  SCHOTTKY RECTIFIER**



• Device is **Halogen Free** by design

# Central™ Semiconductor Corp.

## DESCRIPTION:

The CENTRAL SEMICONDUCTOR CTLSH3-30M833 is a high performance 3.0 Amp Silicon Schottky Rectifier designed for applications where small size and operational efficiency are prime requirements. With a maximum power dissipation of 4.5W, this leadless package design has a watts per unit area at least twice that of equivalent packaged devices.

**MARKING CODE: CHA1**

## FEATURES:

- High Current ( $I_F=3.0A$ )
- High Thermal Efficiency
- Low Leakage/Low  $V_F$
- 3 x 3mm TLM™ case

## MAXIMUM RATINGS: ( $T_A=25^\circ C$ )

	SYMBOL		UNITS
Continuous Reverse Voltage	$V_R$	30	V
Average Forward Current	$I_O$	3.0	A
Peak Forward Surge Current (8.3ms)	$I_{FSM}$	25	A
Power Dissipation (Note 1)	$P_D$	4.5	W
Power Dissipation (Note 2)	$P_D$	4.0	W
Power Dissipation (Note 3)	$P_D$	2.5	W
Operating and Storage Junction Temperature	$T_J, T_{stg}$	-65 to +150	$^\circ C$
Thermal Resistance (Note 1)	$\Theta_{JA}$	27.78	$^\circ C/W$
Thermal Resistance (Note 2)	$\Theta_{JA}$	31.25	$^\circ C/W$
Thermal Resistance (Note 3)	$\Theta_{JA}$	50.00	$^\circ C/W$

## ELECTRICAL CHARACTERISTICS: ( $T_A=25^\circ C$ unless otherwise noted)

SYMBOL	TEST CONDITIONS	MIN	MAX	UNITS
$I_R$	$V_R=30V$		1.0	mA
$BV_R$	$I_R=5.0mA$	30		V
$V_F$	$I_F=500mA$		0.30	V
$V_F$	$I_F=1.0A$		0.35	V
$V_F$	$I_F=2.0A$		0.40	V
$V_F$	$I_F=3.0A$		0.45	V

- Notes: (1) Ceramic or aluminum core PC Board with copper mounting pad area of 75 mm<sup>2</sup>  
 (2) FR-4 Epoxy PC Board with copper mounting pad area of 75 mm<sup>2</sup>  
 (3) FR-4 Epoxy PC Board with copper mounting pad area of 25 mm<sup>2</sup>

R5 (2-September 2009)

**TLM833 CASE - MECHANICAL OUTLINE**

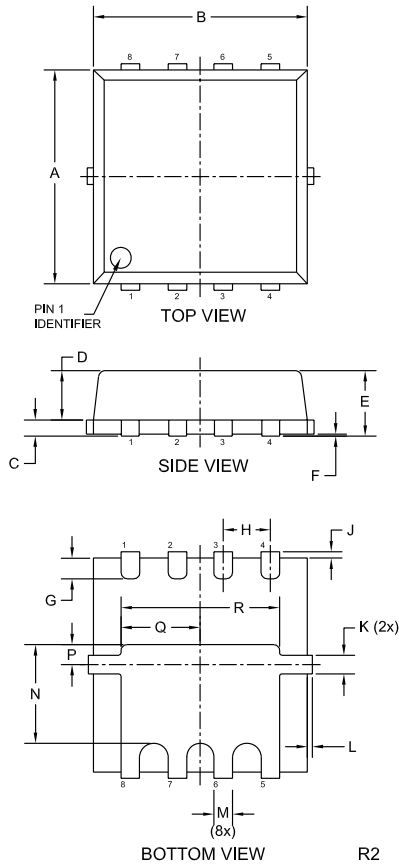

SYMBOL	INCHES		MILLIMETERS	
	MIN	MAX	MIN	MAX
A	0.114	0.122	2.90	3.10
B	0.114	0.122	2.90	3.10
C	0.006	0.010	0.15	0.25
D	0.026	0.030	0.65	0.75
E	0.031	0.039	0.80	1.00
F	0.000	0.002	0.00	0.05
G	0.008	0.018	0.20	0.45
H	0.026		0.65	
J	—	0.005	—	0.125
K	0.007	0.012	0.17	0.30
L	—	0.005	—	0.125
M	0.011	0.015	0.29	0.39
N	0.049	0.057	1.25	1.45
P	0.006	0.014	0.15	0.35
Q	0.040	0.048	1.01	1.21
R	0.085	0.093	2.16	2.36

TLM833 (REV:R2)

**SUGGESTED MOUNTING PADS**  
(Dimensions in mm)

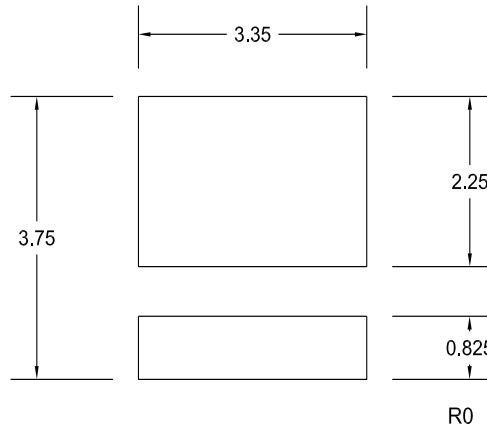

For standard mounting see  
TLM833 package details

**LEAD CODE:**

- 1) ANODE
- 2) ANODE
- 3) ANODE
- 4) ANODE
- 5) CATHODE
- 6) CATHODE
- 7) CATHODE
- 8) CATHODE

**MARKING CODE: CHA1**